

F:\3988 Lincoln Meadows\DWG\SITE PLAN SUBMISSION\3988\_C-04-SITE PLAN.dwg(04) Last Modified: Apr 13, 2023 Plotted by pldelo

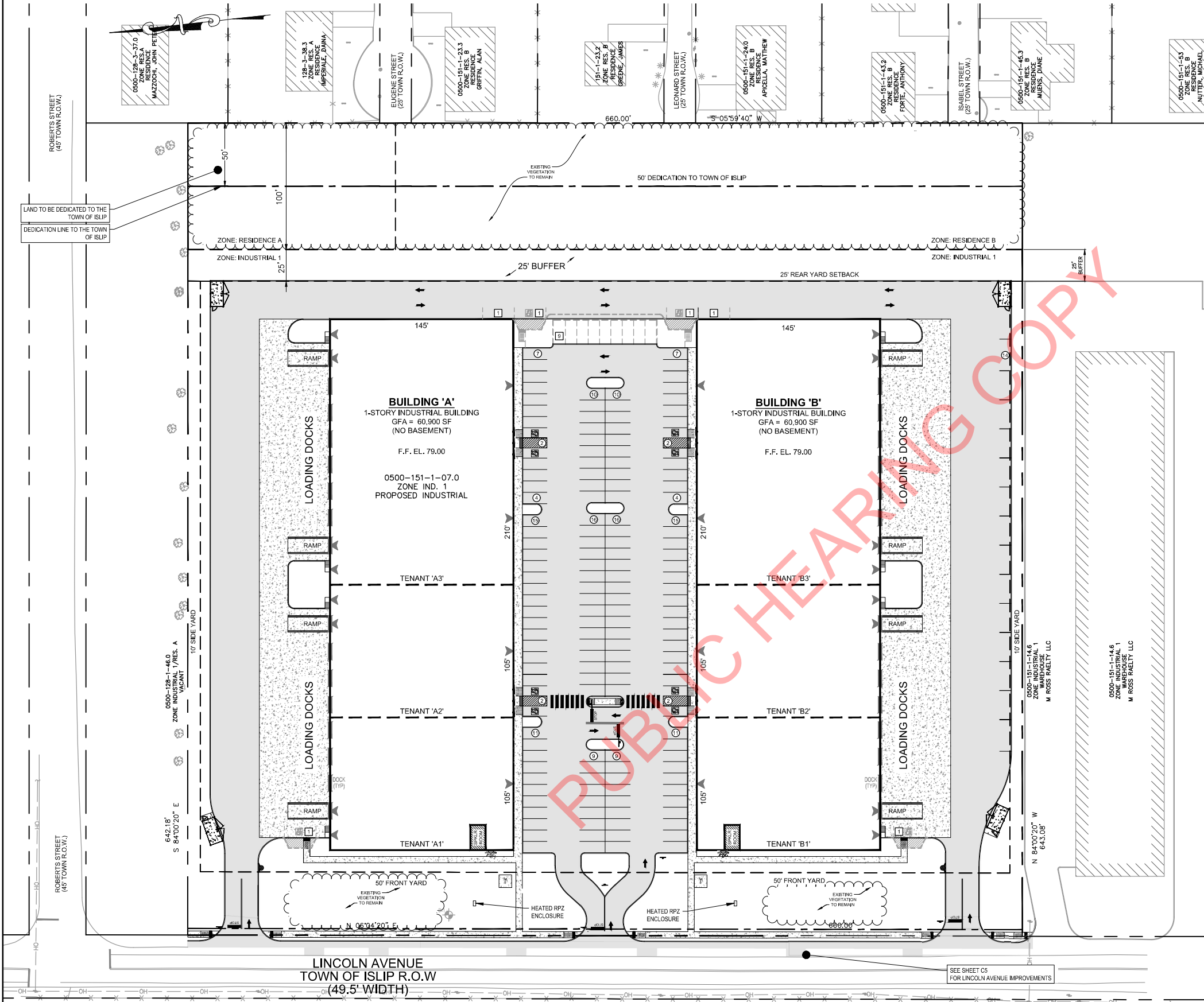

#### TOWN OF ISLIP SITE PLAN NOTES

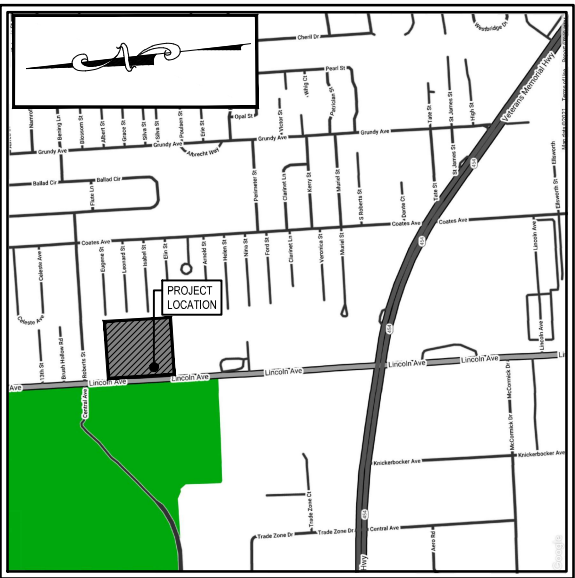





- CONTACT THE ENGINEERING INSPECTOR (631-224-5360) AT LEAST 48 HOURS PRIOR TO START OF ANY WORK. WORK PERFORMED WITHOUT INSPECTION SHALL BE CERTIFIED TO THE TOWN ENGINEER'S SATISFACTION AT APPLICANT'S EXPENSE.
- COORDINATE AND COMPLETE ALL UTILITY RELOCATIONS. ALL UTILITIES SHALL BE INSTALLED BELOW GRADE.
- OBTAIN A TOWN RIGHT-OF-WAY WORK PERMIT PRIOR TO CONSTRUCTION WITHIN THE TOWN RIGHT-OF-WAY (631-224-5610).
- CLEARING LIMIT LINES SHALL BE STAKED OUT BY A LICENSED LAND SURVEYOR, AND EITHER SNOW FENCING OR CONSTRUCTION FENCING SHALL BE ERECTED TO PROTECT AREAS FROM DISTURBANCE OR ENCROACHMENT PRIOR TO THE START OF ANY ACTIVITIES ON SITE. FENCING SHALL NOT BE REMOVED PRIOR TO COMPLETION OF FINAL SITE GRADING OPERATIONS.
- PLACEMENT OF FILL, INSTALLATION OF RETAINING WALLS, DUMPING OF MATERIAL, EXCAVATION, MINING, OR SIMILAR DISTURBANCE OF LAND REQUIRES AN APPROVED SITE PLAN. COMMENCEMENT OF ANY LEGAL ACTION OF THE ABOVE WITHOUT APPROVAL IS PROHIBITED AND SUBJECT TO LEGAL ACTION.
- CONTRACTOR SHALL CONTACT THE FIRE MARSHAL'S OFFICE (631-224-5477) PRIOR TO INSTALLATION OF ANY FIRE SERVICE WATER LINES TO PROVIDE FOR PROPER INSPECTION COORDINATION.
- ALL EXISTING OR PROPOSED SUBSURFACE ELECTRIC, TELEPHONE OR CABLE SERVICES SHALL BE INSTALLED IN APPROPRIATE CONDUIT SLEEVES WHEN PERMANENT, IMPROVED SURFACES ARE PROPOSED OVER THE ROUTING PATH.
- ALL RECYCLED PORTLAND CEMENT CONCRETE AGGREGATE (RCA) AND FILL MATERIALS ARE TO BE FROM AN APPROVED SOURCE. RECYCLED PORTLAND CEMENT CONCRETE AGGREGATE IS TO BE CERTIFIED. DOCUMENTATION IS TO BE PROVIDED SHOWING THAT THE MATERIAL OBTAINED IS FROM A NYSDEC REGISTERED OR PERMITTED CONSTRUCTION AND DEMOLITION (C&D) DEBRIS PROCESSING FACILITY AS SPECIFIED IN SECTION 360-16.1 OF GNYCRR PART 360. SOLID WASTE MANAGEMENT FACILITIES.
- LOAD TICKETS REQUIRED FOR ALL FILL MATERIALS BROUGHT ON SITE. IDENTIFYING THE SOURCE AND QUANTITY OF MATERIALS. ALL FILL TO SATISFY THE REQUIREMENTS OF ISLIP ITEM 28F OR ITEM 28S.
- ALL CONSTRUCTION & DEMOLITION MATERIAL EXPORTED FROM THE SUBJECT PARCEL SHALL BE TRANSFERRED TO AN APPROVED NYSDEC FACILITY. LOAD/TRANSFER TICKETS TO BE RETAINED AND COPIES PROVIDED TO THE TOWN OF ISLIP ENGINEERING INSPECTOR FOR THE RECORD.
- THE TOWN OF ISLIP SUBDIVISION AND LAND DEVELOPMENT REGULATIONS, SECTION P, 5 SHALL BE FOLLOWED.
- APPLICATIONS REQUIRING THE PROVISION OF A STABILIZED CONSTRUCTION ENTRANCE SHALL FOLLOW THE CONSTRUCTION SPECIFICATIONS AS STATED WITHIN THE NEW YORK STANDARDS AND SPECIFICATIONS FOR EROSION AND SEDIMENT CONTROL, PAGES 5A.75 AND 5A.76. CONSTRUCTION AND DEMOLITION DEBRIS MATERIALS SHALL NOT BE CONSIDERED FOR USE WITH STABILIZED CONSTRUCTION ENTRANCE INSTALLATIONS.
- REFUSE FACILITIES SHALL BE MAINTAINED BY THE APPLICANT/OWNER SO AS NOT TO OFFER ANY NOXIOUS OR OFFENSIVE ODORS AND/OR FUMES. APPLICANT/ OPERATOR SHALL MAINTAIN REFUSE ENCLOSURE GATES IN A CLOSED POSITION EXCEPT AT TIMES UNITS ARE BEING ACCESS FOR LOADING OR UNLOADING OF DUMPSTERS.
- PRIOR TO THE ISSUANCE OF ANY CERTIFICATE OF OCCUPANCY, THE DEDICATION(S) TO THE TOWN OF ISLIP MUST BE RECORDED WITH THE SUFFOLK COUNTY CLERK.
- PRIOR TO THE ISSUANCE OF ANY CERTIFICATE OF OCCUPANCY, THE LIGHTING CONTRACTOR OR ELECTRICIAN SHALL PROVIDE AN UNDERWRITER'S LABORATORY CERTIFICATE AND LETTER STATING THE LIGHTS HAVE BEEN ENERGIZED.



LOCATION MAP

1" = 400'

The posted plan is subject to change. Please note that this site plan may be modified during the Town Planning Board and/or Town Board review process. Please contact the assigned planning department staff member if you have questions regarding the date and status of any posted graphics.

	04/14/2023	TOWN OF ISLIP PUBLIC HEARING COMMENTS	PJG
	06/24/2022	TOWN OF ISLIP COMMENTS	JM
	05/09/2022	SCHD COMMENTS	SL
	04/08/2022	TOWN OF ISLIP COMMENTS	JM
	01/04/2022	TOWN OF ISLIP COMMENTS	JM
	12/25/2021	SCHD - SEPTIC SYSTEMS REV PER CODE UPDATES	LDM / SL
NO.	DATE	REVISION	INT.



UNAUTHORIZED ALTERATION OR ADDITION TO THIS DOCUMENT IS A VIOLATION OF SECTION 7209 OF THE NEW YORK STATE EDUCATION LAW.	
PROJECT ENGINEER:	DRAWN BY:
AVC	JM
DESIGNED BY:	CHECKED BY:
JM	RJC



**D&B ENGINEERS  
AND ARCHITECTS**

330 CROSSWAYS PARK DRIVE  
WOODBURY, NEW YORK 11797

TEL : (516) 364 - 9890  
FAX : (516) 364 - 9045

## LINCOLN AVENUE INDUSTRIAL DEVELOPMENT

SCTM # 0500-151.00-01.00-007.000

SITUATED IN LINCOLN AVENUE, HOLBROOK, TOWN OF ISLIP, SUFFOLK COUNTY, NEW YORK STATE

SP2021 - 063 SCTM 0500-151.00-01.00-007.000		PROJECT NO. 3968	SHEET NO. 04 OF 27
OVERALL SITE PLAN		DATE: AUGUST 2021	DRAWING NO. <b>C1</b>
CIVIL		SCALE: 1" = 40'	