

The posted plan is subject to change. Please note that this site plan may be modified during the Town Planning Board and/or Town Board review process. Please contact the assigned planning department staff member if you have questions regarding the date and status of any posted graphics.

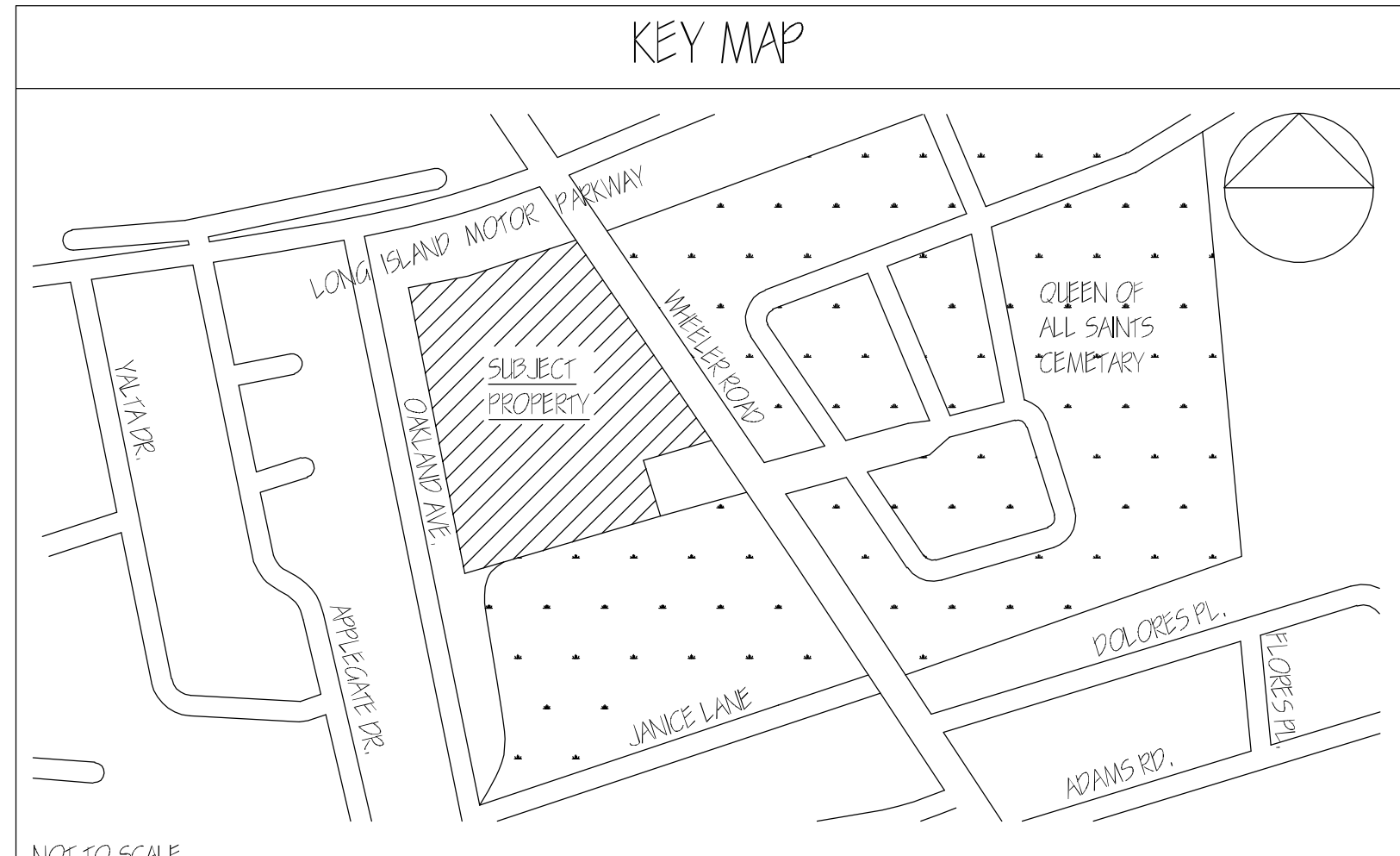

<p>VANDERBILT PLAZA SHOPPING CENTER</p> <p>WHEELER ROAD CENTRAL ISLIP NEW YORK</p>	<p>APPLICANT/PROPERTY OWNER: Vanderbilt Plaza, LLC 500 North Broadway Suite 270 Jericho, NY 11753 (516)939-0500</p> <p>THESE DRAWINGS ARE AN INSTRUMENT OF SERVICE, AND AS SUCH ARE THE PROPERTY OF THOMAS P. WALSH, ARCHITECT, P.C. ANY UNAUTHORIZED USE OF THESE DOCUMENTS IS IN A VIOLATION OF SECTION 7209 SUB-DIVISION 2 OF THE N.Y. STATE EDUCATION LAW.</p>	<p>ISSUED TO T.O.I REVISION</p> <p>7-1-21 DATE</p>		<p>THOMAS P. WALSH, ARCHITECT P.C.</p> <p>15 ORLEANS COURT COMMACK, NEW YORK 11725 (631)662-4404</p> <p>NO: BY: DATE: PAGE:</p> <p>SP-1</p>
--	--	--	--	---